



FILOMAT

ACCESSORI ZINCATI

ZINC-PLATED CLIPS AND ACCESSORIES

MORSETTI BASE GHISA

ZINC-PLATED CAST IRON BASE WIRE ROPE CLIPS



Cod.	Inches Pollici	mm.		EAN
M605	1/8	M3	100	-
M606	3/16	M5	100	-
M607	1/4	M6	100	-
M608	5/16	M8	50	-
M610	3/8	M10	50	-

MORSETTI "SIMPLEX" ZINCATI

"SIMPLEX" ZINC-PLATED WIRE ROPE CLIPS



Cod.	mm.		EAN
M620	M2	400	-
M621	M3	100	-
M622	M4	200	-
M623	M5	100	-
M624	M6	100	-

MORSETTO PRATICO E SICURO

PRACTICAL CLIPS



Cod.	Description Descrizione		EAN
2300	Morsetto piccolo/Small clips	100	-
2400	Morsetto medio/Medium clips	50	-

GRILLI DRITTI ZINCATI

DEE-SCREW PIN SHACKLES



Cod.	mm.		EAN
GZ50	5 MA	100	-
GZ60	6 MA	100	-
GZ80	8 MA	50	-
GZ100	10 MA	30	-
GZ120	12 MA	15	-

MOSCHETTONI ZINCATI

ZINC-PLATED SNAP HOOKS



Cod.	mm.		EAN
MZ40	4x40	100	-
MZ60	6x60	100	-
MZ80	8x80	50	-
MZ100	10x100	25	-
MZ120	11x120	20	-



ACCESSORI ZINCATI ZINC-PLATED CLIPS AND ACCESSORIES

MORSETTO 1 VITE IN TESTA ESAGONALE

ZINC-PLATED CLIP WITH OVERHEAD SCREW



Cod.	D	d	L1	L2	F	Ch		EAN
M594	8	M5	11	8	3	7	100	-
M596	10	M6	15	10	3,5	10	100	-



MORSETTO 2 VITI IN TESTA ESAGONALI

ZINC-PLATED CLIP WITH DOUBLE OVERHEAD SCREW



Cod.	D	d	L1	L2	F	Ch		EAN
M597	8	M5	20	8	3	7	100	-



MORSETTO 1 VITE LATERALE

ZINC-PLATED CLIP WITH SIDE SCREW



Cod.	D1	D2	d1	d2	L1	L2	Ch		EAN
M599	8	5	M4	3	9	3	6	100	-
M601	10	5	M5	4	10	5	7	100	-

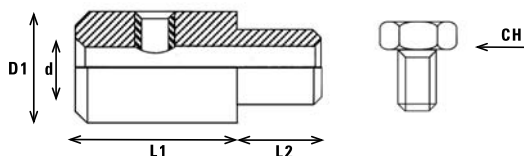

MORSETTO 2 VITI LATERALI

ZINC-PLATED CLIP WITH DOUBLE SIDE SCREW



Cod.	D	d1	d2	L	Ch		EAN
M603/A	12	M5	4,5	20	8	50	-

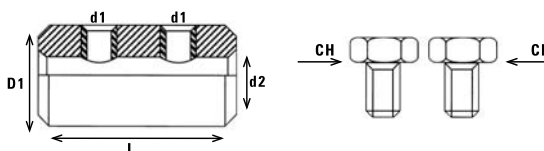

TIRAFILO PER RECINZIONI

MESH TYING TURNBUCKLES



Cod.	N.	Dimensioni Dimensioni	Type Tipo		EAN
TZ 610	2	25 x 90	Zincato/Zinc plated	100	-
TZ 611	3	34 x 100	Zincato/Zinc plated	50	-
TV 613	2	25 x 90	Verde/Green	100	-
TV 614	3	34 x 100	Verde/Green	50	-



FILOMAT

ACCESSORI ZINCATI

ZINC-PLATED CLIPS AND ACCESSORIES

TENDITORI OCCHIO E GANCIO

TURNBUCKLES EYE AND HOOK



Cod.	mm.		EAN
TOGM5	5	100	-
TOGM6	6	50	-
TOGM8	8	30	-
TOGM10	10	20	-
TOGM12	12	10	-

TENDITORI A DUE OCCHI ZINCATI

ZINC-PLATED EYE-EYE TURNBUCKLES



Cod.	mm.		EAN
T2MA5	5	100	-
T2MA6	6	50	-
T2MA8	8	30	-
T2MA10	10	20	-
T2MA12	12	10	-

GANCI AL CARBONIO CON SICURA

CARBON STEEL EYE HOOKS WITH LATCH



Cod.	Ton.		EAN
GOS10	1	50	-
GOS16	1,6	30	-
GOS20	2	25	-
GOS50	3,2	5	-

GOLFARI

EYEBOLTS



Cod.	mm.		EAN
GOM6	6	50	-
GOM8	8	50	-
GOM10	10	50	-
GOM12	12	20	-

MANICOTTI IN ALLUMINIO - PINZA PER MANICOTTI

ALUMINUM CRIMP FERRULES - CRIMPER



Cod.	Ø mm.	Type Tipo		EAN
MAN15	1,50	-	100	-
MAN20	2	-	100	-
MAN30	3	-	100	-
MAN40	4	-	100	-
MAN50	5	-	100	-
PINZ1	1/3	Pinza/Crimper	1	-
PINZ2	1/5	Pinza/Crimper	1	-